

# Lighting

## Emergency luminaire For fluorescent lamps

GRP

6009/522-9617-1611-71 Art. No. 225723



- Can be used in Ex Zones 1, 2, 21 and 22
- Two fluorescent lamps: 18 W and 36 W
- Weekly function test and annual emergency light duration test

WebCode 6009A



The 6009 series EXLUX emergency luminaire is suitable for use as safety lighting. It is lightweight and requires minimal maintenance. The battery is housed in the external enclosure and powers the emergency lighting for 1.5 or 3 hours. If one lamp is faulty, the luminaire switches to the working lamp. When the central lock is opened, the luminaire is always disconnected from the power supply at all poles.

### Technical Data

#### Explosion Protection

Application range (zones)	1 2 21 22
IECEX gas certificate	IECEX PTB 13.0059
ATEX gas certificate	PTB 13 ATEX 2015
IECEX dust certificate	IECEX PTB 13.0059
ATEX dust certificate	PTB 13 ATEX 2015
Certificate EAC	TS RU S-DE.GB04.B.00264
Ambient temperature °C	-20 ... +50 °C
Note: Through wiring	Max. 3x16 A
Gas explosion protection IECEX	Ex de mb IIC T4 Gb
Gas explosion protection ATEX	⊕ II 2 G Ex de mb IIC T4 Gb
Gas explosion protection EAC	1 Ex d e mb IIC T4 Gb
Dust explosion protection IECEX	Ex tb IIIC T80 °C Db
Dust explosion protection ATEX	⊕ II 2 D Ex tb IIIC T80 °C Db
Dust explosion protection EAC	Ex tb IIIC T80 °C Db
Certificates	ATEX (PTB), Brazil (ULB), China (CQST), EAC (STV), IECEX (PTB), Polen (CNBOP)
Ship approval	BVIS, DNVGL
Languages of the documentation	Brazil French Spanish English German Russian

#### Electrical Data

Ex version	Yes
------------	-----

# Lighting

## Emergency luminaire For fluorescent lamps

### GRP

6009/522-9617-1611-71 Art. No. 225723



#### Electrical Data

Rated operational voltage AC	220 – 240 V
Rated operational voltage AC	220 – 240 V
Rated operational voltage max. AC	240 V
Rated operational voltage min. AC	220 V
Battery operating voltage	6 V
Battery capacity	7 Ah
Frequency range	50 – 60 Hz
Self-test function	With (standard)
Lamp wattage	18 W

#### Lighting Data

Number of Lamps	2
Lamp wattage	18 W
Lamp	G13 lamp base
Luminaire efficacy	0 lm/W
Luminous flux	0 lm
Operating time	1.5 / 3h emergency lighting operation
Emergency light mode	Continuous light Or stand-by light
Colour temperature	0 K

#### Ambient Conditions

Ambient temperature °F	-999 - -999 °F
Ambient temperature min.	-20 °C
Ambient temperature max.	+50 °C
Ambient temperature	-20 °C ... +50 °C

#### Mechanical Data

Version	Standard
Degree of protection IP (IEC 60598)	IP66 / IP67
Protection class	I (with inner PE connection)
Enclosure material	Polyester resin, Glass fibre reinforced
Sealing material	Silicone
Material translucent cover	Polycarbonate
Installed terminal strip	PE + N + L1 + L2 + L3 + L´
Connection terminals solid max.	4 mm <sup>2</sup>
Connection terminals finely-stranded max.	4 mm <sup>2</sup>
Lighting lock	Central lock , For box spanner actuation
Type of connection cable	Finely stranded Solid
Design size	2
Width	183.5 mm
Height	125 mm
Length	857 mm
Impact strength (IK code)	IK10 (IEC 62262)
Enclosure colour	Light grey (RAL 7035)
Weight	7.6 kg

# Lighting

## Emergency luminaire For fluorescent lamps

### GRP

6009/522-9617-1611-71 Art. No. 225723



#### Components

Threaded plate	2x plastic
Ballast	6043-792-201
Through wiring	With 6 conductors 2.5 mm <sup>2</sup>
Battery-Version	NiCd battery, gas-tight
Drilled holes	3 x M25
Screw connections	2 x M25 Ø 7 – 17 mm
Material of screw connections	Polyamide, black
Stopping plug	2 x M25 x 1.5
Stopping plug material	Polyamide, black

#### Dimensional Drawings (All Dimensions in mm [inches]) – Subject to Alterations

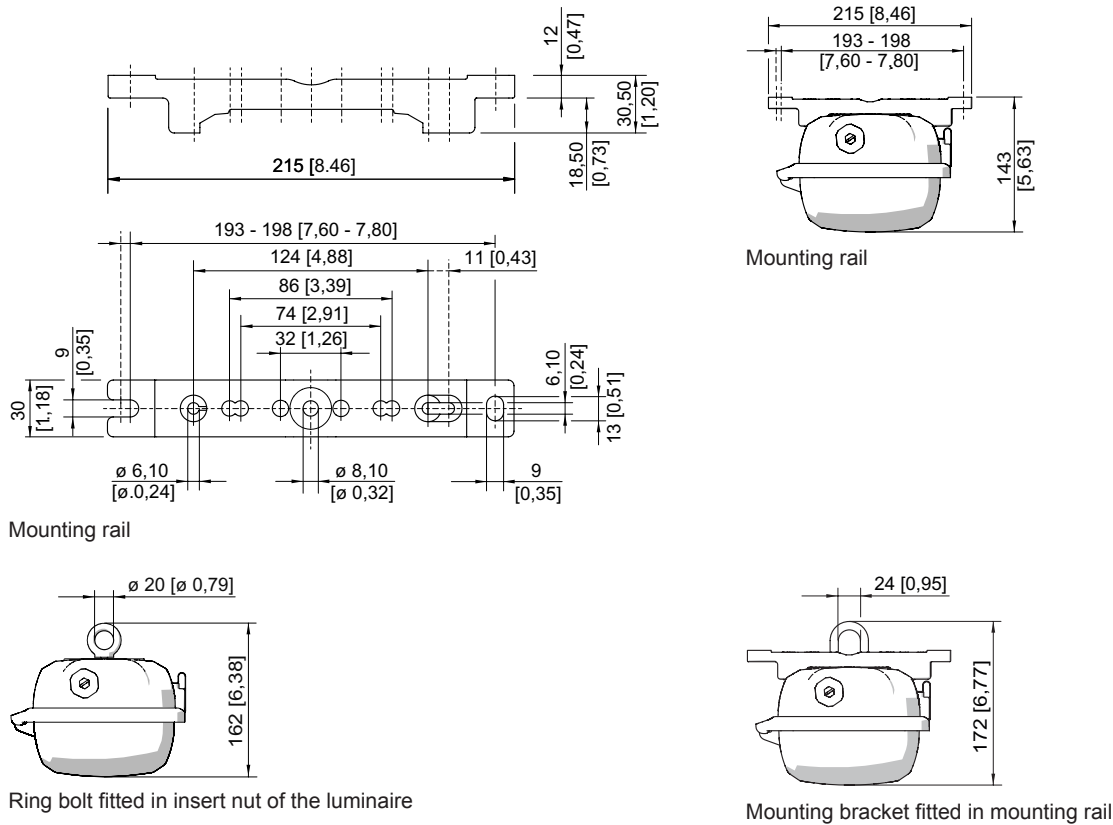

# Lighting

## Emergency luminaire For fluorescent lamps

### GRP

6009/522-9617-1611-71 Art. No. 225723

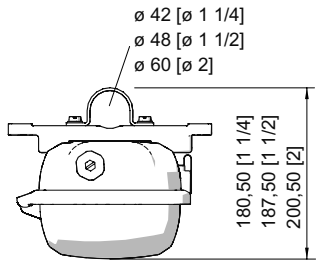

Pipe clamp fitted in mounting rail

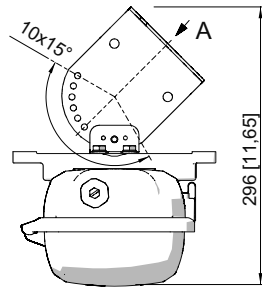

A

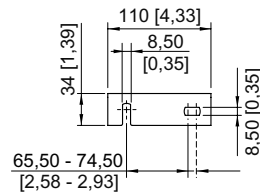

Wall mounting bracket fitted in mounting rail

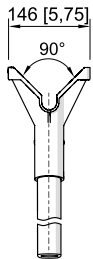
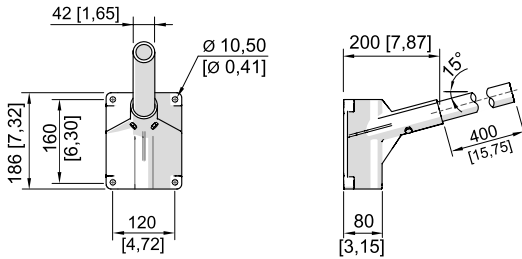

Bracket for wall mounting with pipe section

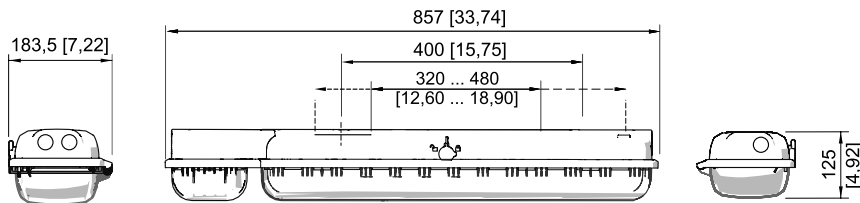

Size 2

## Accessories and Spare Parts

### Battery set

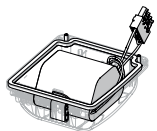

Battery cover with built-in battery. Gas-tight NiCd battery; 7 Ah / 6 V

Art. No.

223532

# Lighting

Emergency luminaire For fluorescent lamps

GRP

6009/522-9617-1611-71 Art. No. 225723

STAHL

## Bracket for wall mounting with tube

Art. No.

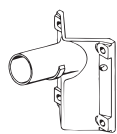

for side entry lamp; with tube, length 400 mm, d 42 mm

108947

## Breather

Art. No.

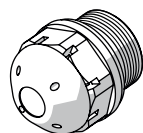

Thread: M25 x 1.5; 1 pc; for installation in lights; in moulded material; without counter nut

138573

Thread: M25 x 1.5; 20 pc; for installation in lights; in moulded material; without counter nut

138576

## Ceiling and wall mounting bracket

Art. No.

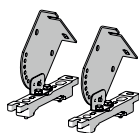

mounted on a mounting rail for a variable mounting distance; Material: stainless steel; Lamp can be swiveled in steps of 15°; 1 pair

222827

## Contact Element

Art. No.

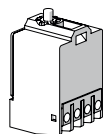

8080/1-3-L 2 NC contact element

132527

## Cover

Art. No.

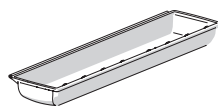

for luminaire size 2

222427

## Fluorescent lamp

Art. No.

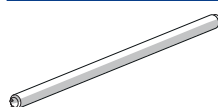

18 W, 1350 lm

108952

## Lamp holder

Art. No.

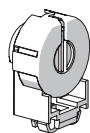

G13 Ex e lamp holder for light fittings with T8 fluorescent lamps for use in Zone 1

117252

## Mounting bracket

Art. No.

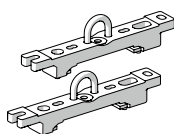

mounting clamp mounted on a mounting rail for a variable mounting distance; 1 pair

222456

## Mounting rail

Art. No.

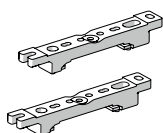

for a variable mounting distance; 1 pair

222826

# Lighting

Emergency luminaire For fluorescent lamps

GRP

6009/522-9617-1611-71 Art. No. 225723



## Pipe clamp

Art. No.

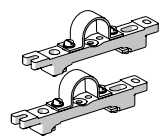

R 1 1/2"; with mounting rail for a variable mounting distance; Material: stainless steel; 1 pair

222459

R 1 1/4"; with mounting rail for a variable mounting distance; Material: stainless steel; 1 pair

222458

R 2"; with mounting rail for a variable mounting distance; Material: stainless steel; 1 pair

222460

## Pole mounting sleeve

Art. No.

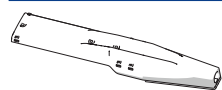

for the subsequent mounting on lights size 2 and size 4, completely with assembly parts

227512

## Ring bolt

Art. No.



M8, direct mounting in insert nuts; 1 pair

115736

## Socket Key

Art. No.

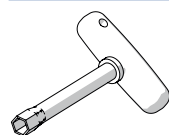

M8 / wrench size 13;  
to open/close the central locking

222430

## Cover

Art. No.

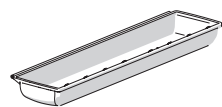

for luminaire size 2 (resistant to aromatic substances)

256534

We reserve the right to make alterations to the technical data, dimensions, weights, designs and products available without notice. The illustrations cannot be considered binding.